

Product Details

CL008 Flexible Linear Light

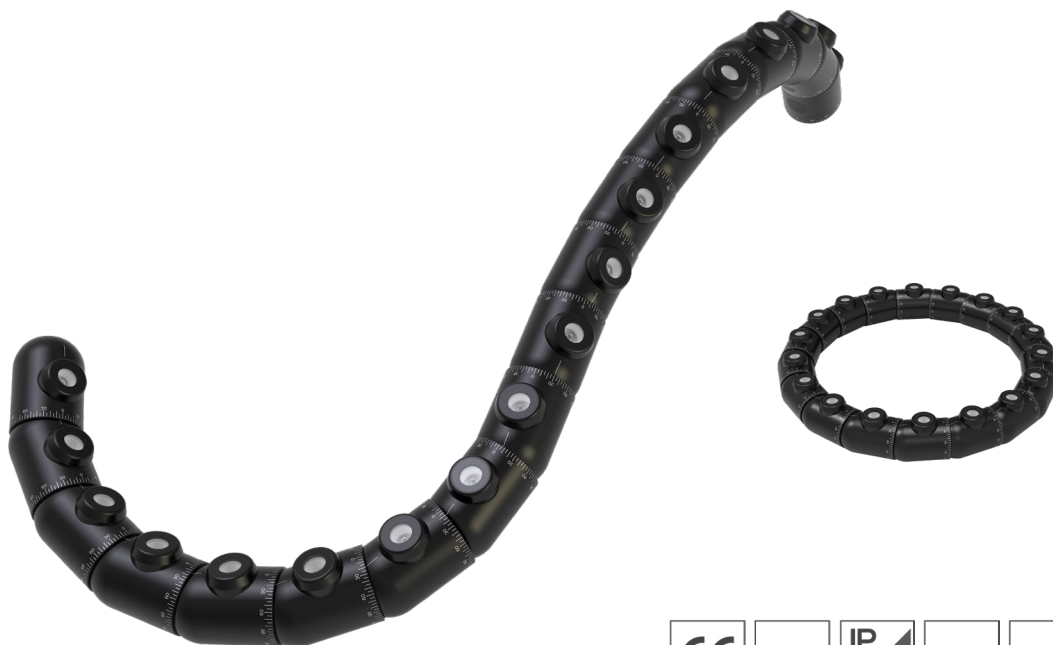

Philips chips, CRI 90
Lens 15° / 25° / 25° x50°



Seamlessly interconnected joints with graduation



Horizontally & Vertically, it can be bent to form nearly any desired curve

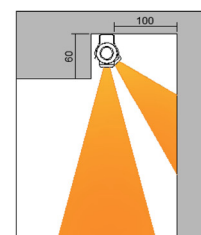
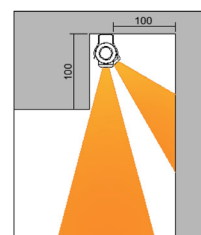
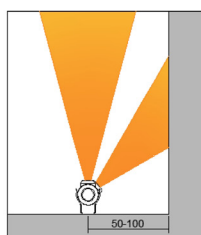
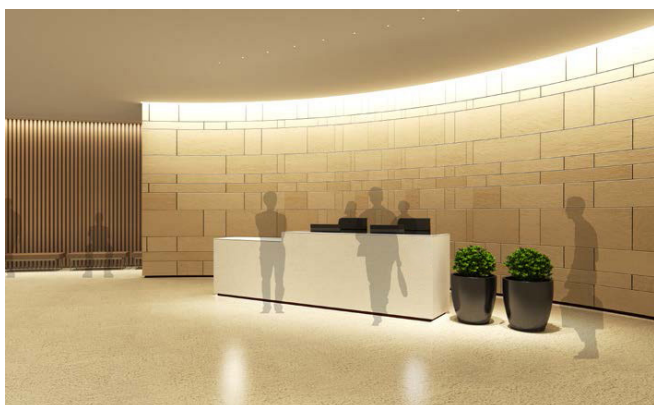

This flexible wallwasher adjusts at multiple points, achieving effects that typically require two or more fixtures, and ensuring seamless integration without obstructing HVAC systems and other ceiling utilities.

Spec guide



- Precision lighting in multiple directions.
- Suitable for specialized and refined settings
- Philips LED chips, CRI 90
- IP67, suitable for indoor and outdoor applications

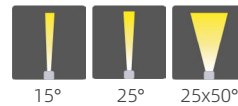
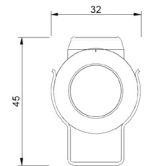
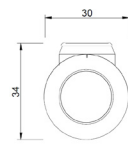

Item No.	Power	Length	Beam Angle	Lumen	Input Current
CL008	15W 30W	L=294mm L=510mm	15° 25° 25x50°	85 lm/W	Constant Current 600mA

Light distribution curve

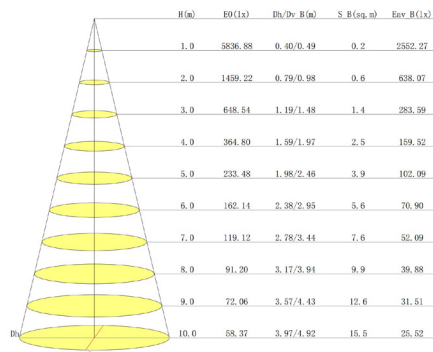
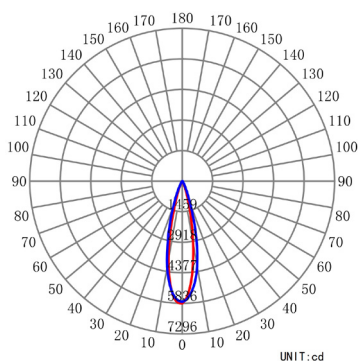

Colour temperature - CRI

2400K - CRI > 90
 2700K - CRI > 90
 3000K - CRI > 90
 4000K - CRI > 90

IP protection rating

IP67

Dimmable

Triac
 PWM
 0~10V
 DALI

Accessories